



MEMS Mass Flow Meters

With calorimetric sensing

MF4700 Series

MF4700 series mass flow meters are designed for general purpose flow metering and control applications and are made with Siargo's proprietary MEMS mass flow sensing technology and smart electronic circuitry. The meters directly measure mass flow with a very low pressure loss. It is a replica of the MF4000 but with a higher pressure rating, excellent for industrial process monitoring with remote data. The current models can be readily applied to industrial gas process and control, gas; and other applications in laboratory and test benches

MF4700 can measure a flow up to 300 SLPM. The connectors can be fully customized.

Dimensions

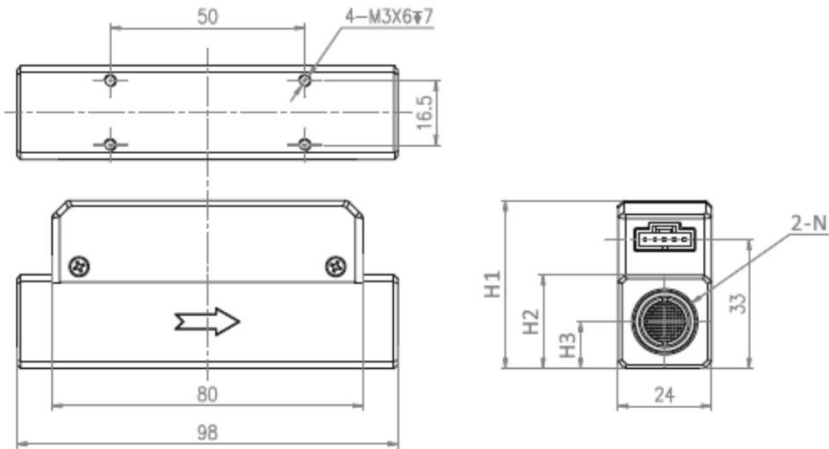

Siargo Ltd.
Santa Clara, California
www.Siargo.com
408.969.0368
info@Siargo.com



Specifications

Flow range	0~0.5(MF4701) / 0~5(MF4703) / 0~50(MF4708) 0~100 (MF4710)/ 0~300 (MF4712) / 0~800 (MF4719)	SLPM
Accuracy	±(1.5+0.5FS)	%
Repeatability	0.5	%
Power supply	8~24 (50mA)	Vdc
Output	LED / RS485 / analog 0.5~4.5Vdc	
Pressure rating	1.0	MPa
Temperature	-10 ~ 55	°C
Humidity	<95 (no condensation)	%RH
Pin-out	CD R-5, 5 pin	
Calibration	Air @ 20°C, 101.325 kPa	
Mechanical	NPT or BSPT	

Note: Parameters specified at the calibration conditions.

Product selection

MF/FS47 - - - -



Gas: A – air; C – CO₂; N – N₂; O – O₂; R – Ar.
For other gases, please contact the manufacturer.

Output: V – Analog B – RS485

Full scale flow rate: 0.01 ... 800 SLPM

Connector: N – NPT; B – BSPT; X – Customized

DN: 01, 03, 08, 10, 12, 19

Model	Full scale (SLPM)	Model	Full scale (SLPM)	Model	Full scale (SLPM)
4701	0.5	4708	50.0	4712	300.0
4703	5.0	4710	100.0	4719	800.0

- Note:**
- The above table shown are full scale range, the ranges within the full scale can be ordered as a customized range. For CO₂, the full-scale flow rate is 80% of air.
 - The default flow range is 100:1 – or the minimal flow rate is 0.01 times the full scale.
 - MF – with LED display; FS – without display.